

LOCATION MAP
 1" = 1000'

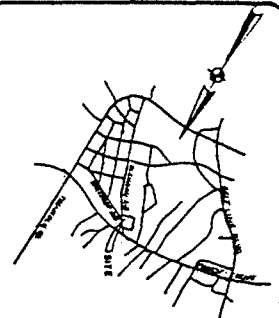

General location of site is shown on the location map. The site is bounded by the following streets: N/1/2 Canton School, N/1/2 DeLoach, N/1/2 Califf, N/1/2 Bantz, N/1/2 McDonald, and N/1/2 McDonald. The site is bounded by the following streets: N/1/2 Califf, N/1/2 Bantz, N/1/2 McDonald, and N/1/2 McDonald. The site is bounded by the following streets: N/1/2 Califf, N/1/2 Bantz, N/1/2 McDonald, and N/1/2 McDonald.

N/1/2 CANTON SCHOOL

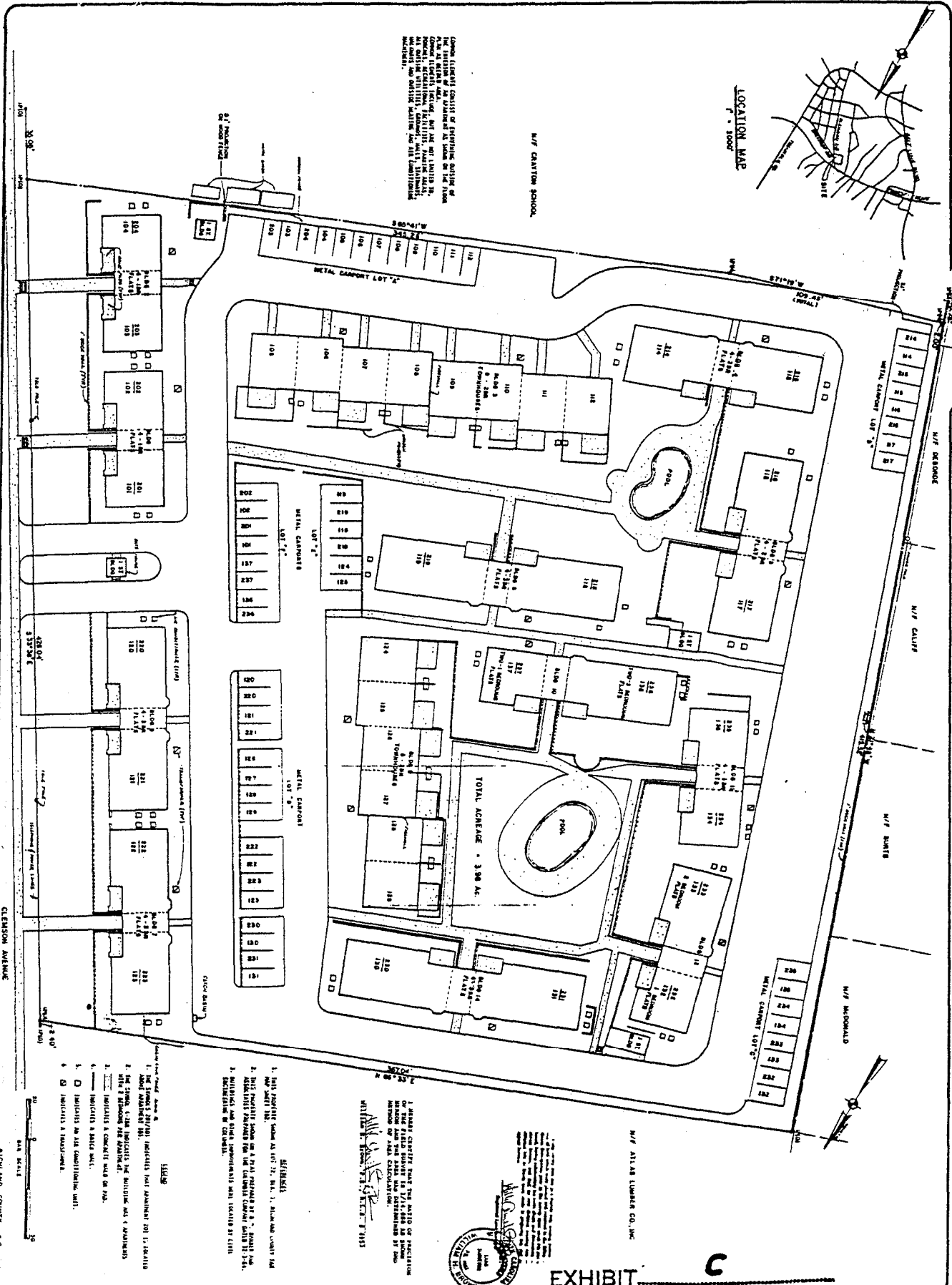

1. I HEREBY CERTIFY THAT THE METHOD OF PREPARATION OF THIS PLOT PLAN IS IN ACCORDANCE WITH THE METHOD OF AEA CALCULATION.
 2. I HEREBY CERTIFY THAT THE METHOD OF PREPARATION OF THIS PLOT PLAN IS IN ACCORDANCE WITH THE METHOD OF AEA CALCULATION.
 3. I HEREBY CERTIFY THAT THE METHOD OF PREPARATION OF THIS PLOT PLAN IS IN ACCORDANCE WITH THE METHOD OF AEA CALCULATION.
 4. I HEREBY CERTIFY THAT THE METHOD OF PREPARATION OF THIS PLOT PLAN IS IN ACCORDANCE WITH THE METHOD OF AEA CALCULATION.
 5. I HEREBY CERTIFY THAT THE METHOD OF PREPARATION OF THIS PLOT PLAN IS IN ACCORDANCE WITH THE METHOD OF AEA CALCULATION.

EXHIBIT C

- LEGEND
1. THE SHOWN'S SYMBOL INDICATES THAT A UNIT IS TO BE CONSIDERED AS A UNIT.
 2. THE SHOWN'S SYMBOL INDICATES THAT A UNIT IS TO BE CONSIDERED AS A UNIT.
 3. THE SHOWN'S SYMBOL INDICATES THAT A UNIT IS TO BE CONSIDERED AS A UNIT.
 4. THE SHOWN'S SYMBOL INDICATES THAT A UNIT IS TO BE CONSIDERED AS A UNIT.
 5. THE SHOWN'S SYMBOL INDICATES THAT A UNIT IS TO BE CONSIDERED AS A UNIT.

Scale 1" = 20'	<p>PREPARED FOR THE CAMPBELL HILL PROPERTY RESUME</p>		<p>CIVIL ENGINEERING OF COLUMBIA CONSULTING ENGINEERING, SURVEYING AND PLANNING</p>	<p>1" = 20' SCALE BASED ON 1" = 20' TO 1"</p>
<p>DATE 1-2-81</p> <p>PROJECT NAME</p> <p>PROJECT NO. 80105</p>				